

Colour:- Dark Grey Metallic finish REF IGP-Dura code 581ME7131A10

Crittall White Akzo Nobel Interpon D36 Matt (30%) SA261ERAL9911

DISCLAIMER:-

Lockmetal will not be responsible for any damage to the balustrade glass due to fixing details.

Org No Stage Type No Issue

13433_DET_302_(C)



Manor Wharf • 20 Old Mill Road • Hutton Bridge • Kings Langley • WD4 8QT •

Produced for

John Sisk & Sons Ltd

Project title

Lewisham gateway Phase 1B

Works description

Balcony fascia

Drawing title

Section through sides of projecting balconies

Scale

1:5

SIZE

A3

ISSUE	DATE	DRAWN	
A	20.10.16	R.B	First Issue
B	10.01.17	AAL	Second issue
C	14.01.17	AAL	Third issue

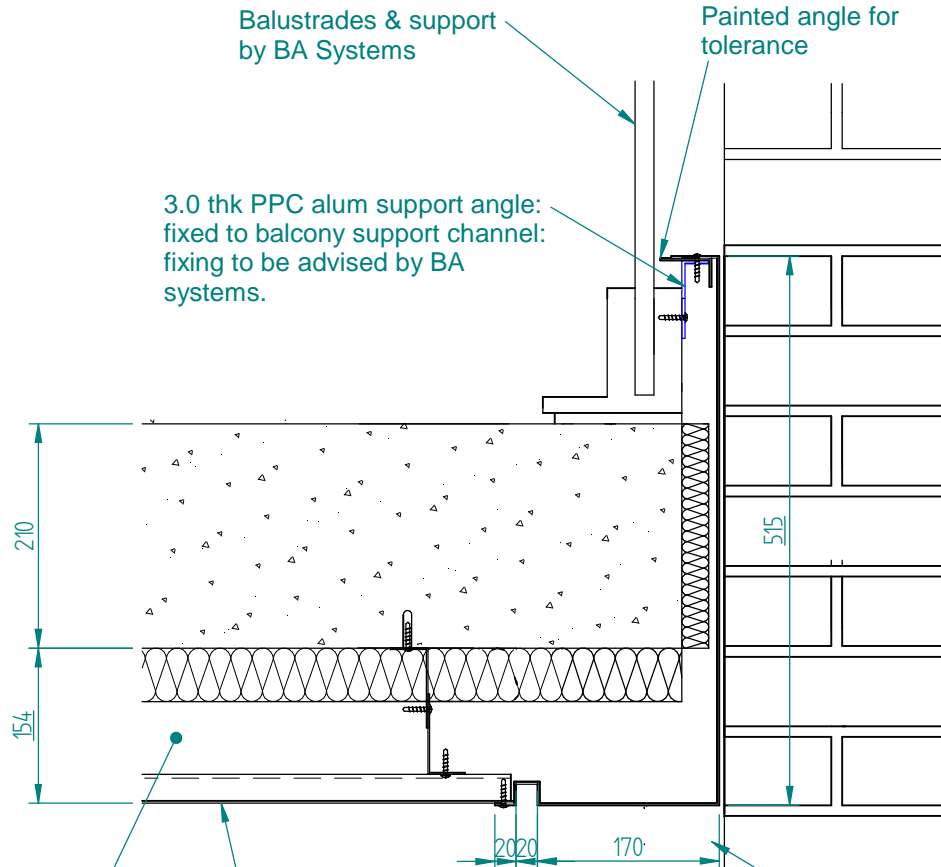

Balustrades & support by BA Systems

Painted angle for tolerance

3.0 thk PPC alum support angle: fixed to balcony support channel: fixing to be advised by BA systems.

2 no 1.5 thk G.B.M support angles: 5.5 x 25 st.st panhead screw @ 600cc with plastic plugs into the concrete 5.5 x 32 st.st drillscrews @ 600cc

2.0 thk PPC alum soffit panels: internal joint straps @ 3000cc: 4.8 x 25 st.st flangehead drillscrews @ 600cc. (White)

2.0 thk PPC alum fascia: internal joint straps @ 3000cc: 4.8 x 25 st.st flangehead drillscrews @ 600cc for top fixing & bottom fixing Ø 4 x 12 alum rivit @ 600cc. (Dark Grey)

Section through the sides of the projecting balconies